

SUBFLOOR SYSTEM CONNECTION:

Subject To Field Inspection

- 1. (8) 16d NAILS
STAGGERED AT EACH
SIDE OF TOP PLATE
SPLICED.
- 2. (3) 16d NAILS
STAGGERED AT EACH
SIDE OF BOTTOM
PLATE SPLICE.

EXISTING 4" SLAB
ON GRADE
2X4 PT MUD SILL
FOAM SILL SEALER
BETWEEN TREATED
PLATE AND CONC

3"X3-1/2" GALV
BEARING PLATES

1/2" J.BLOTS

- 3. (2) 16d NAILS @ 16"
OC INTO STUDS (3) 16d
NAILS FOR SWB ADN
GREATER SHEAR
WALLS PER
CRYSTALITE
- 4. SIMPSON 36" CS14
MAY BE USED IN LIEU
OF NAILING AS
INDICATED (NOT
SHOWN FOR CLARITY

NOTE: PLATE SPLICE
APPLIES WHEN NO
OTHER SPLICE IS
INDICATED

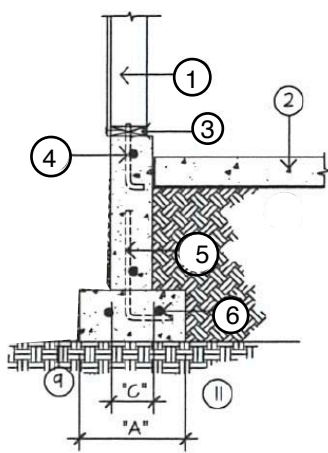
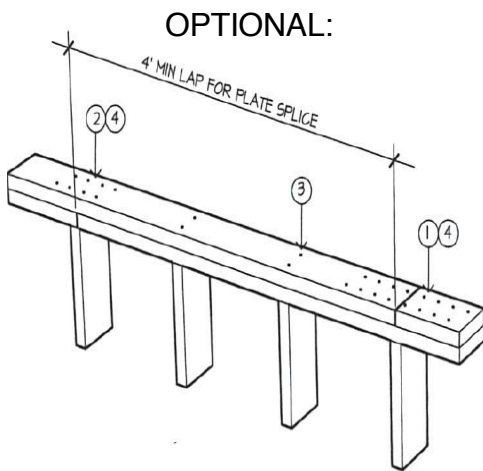

- 1. 2X4 STUD WALL PER PLAN
- 2. 4" EXISTING CONCRETE SLAB
- 3. 2X4 PT HF W/ANCHOR BOLTS
PER SHEAR WALL SCHEDULE
PRODUCED BY CRYSTALITE
- 4. EXISTING #4 HORIZONTAL @
12" OC
- 5. EXISTING #4 VERTICALS @ 24"
OC
- 6. EXISTING (2) #4 @ BOTTOM OF
FTG 3" MIN COVER
- 7. NATIVE UNDISTURBED SOIL